

0₃

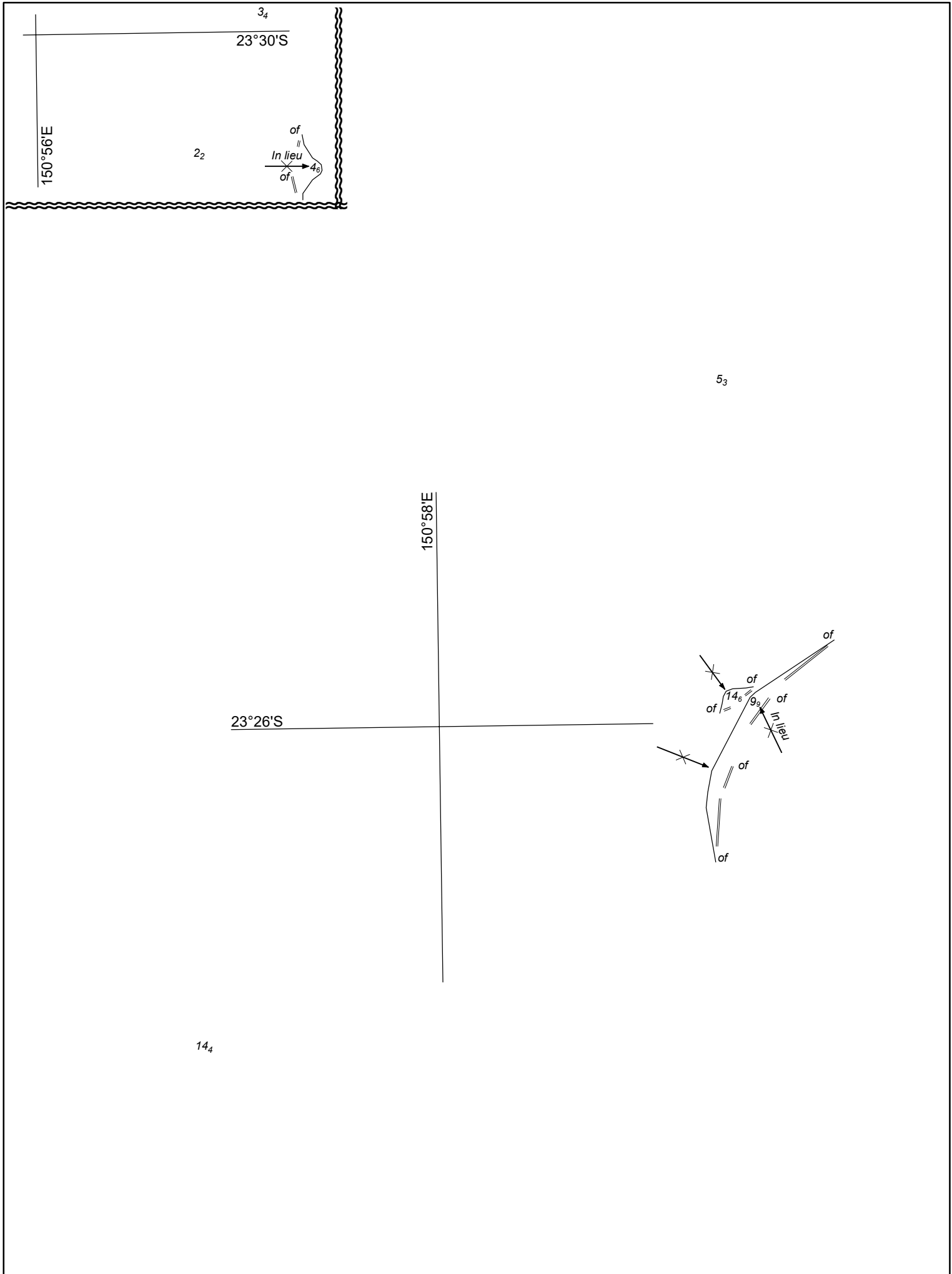

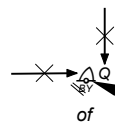

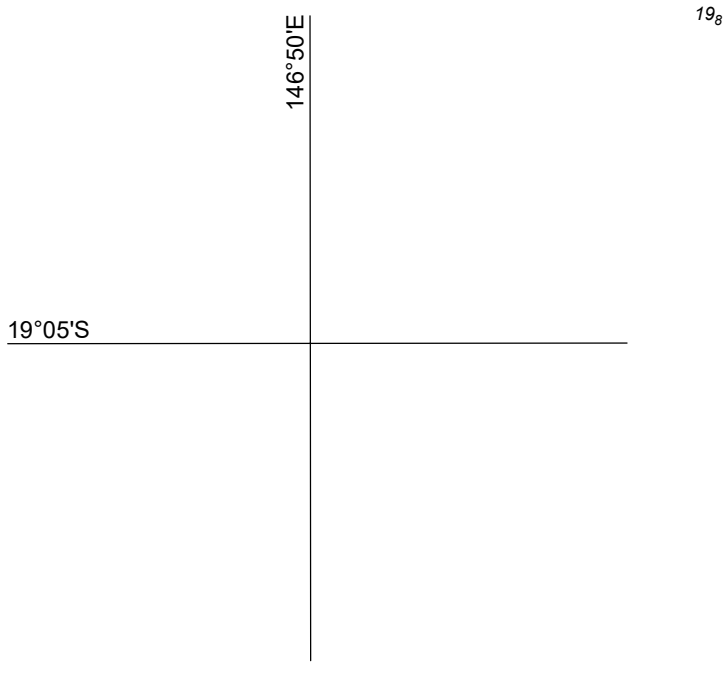

3₆

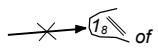

23°09'50'S

150°47'50'E

6₆

PLAN: ROSSLYN BAY

Previous Notice 1190/2019

NTM 744/2020



AUS 247

© Commonwealth of Australia 2020

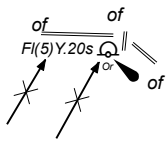

237

123°30'E

14°00'S

126

Previous Notice 480/2020

NTM 745/2020



Australian Government
Department of Defence

AUS 319

© Commonwealth of Australia 2020

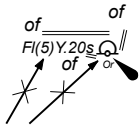

254

14°00'S

123°30'E

96

Previous Notice 1146/2019

NTM 745/2020



AUS 320

© Commonwealth of Australia 2020

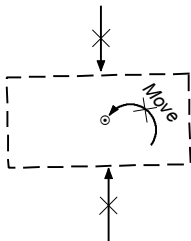
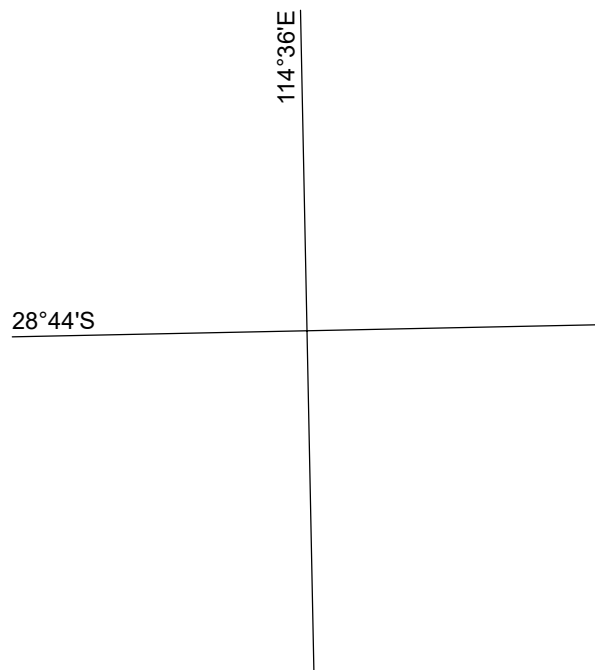

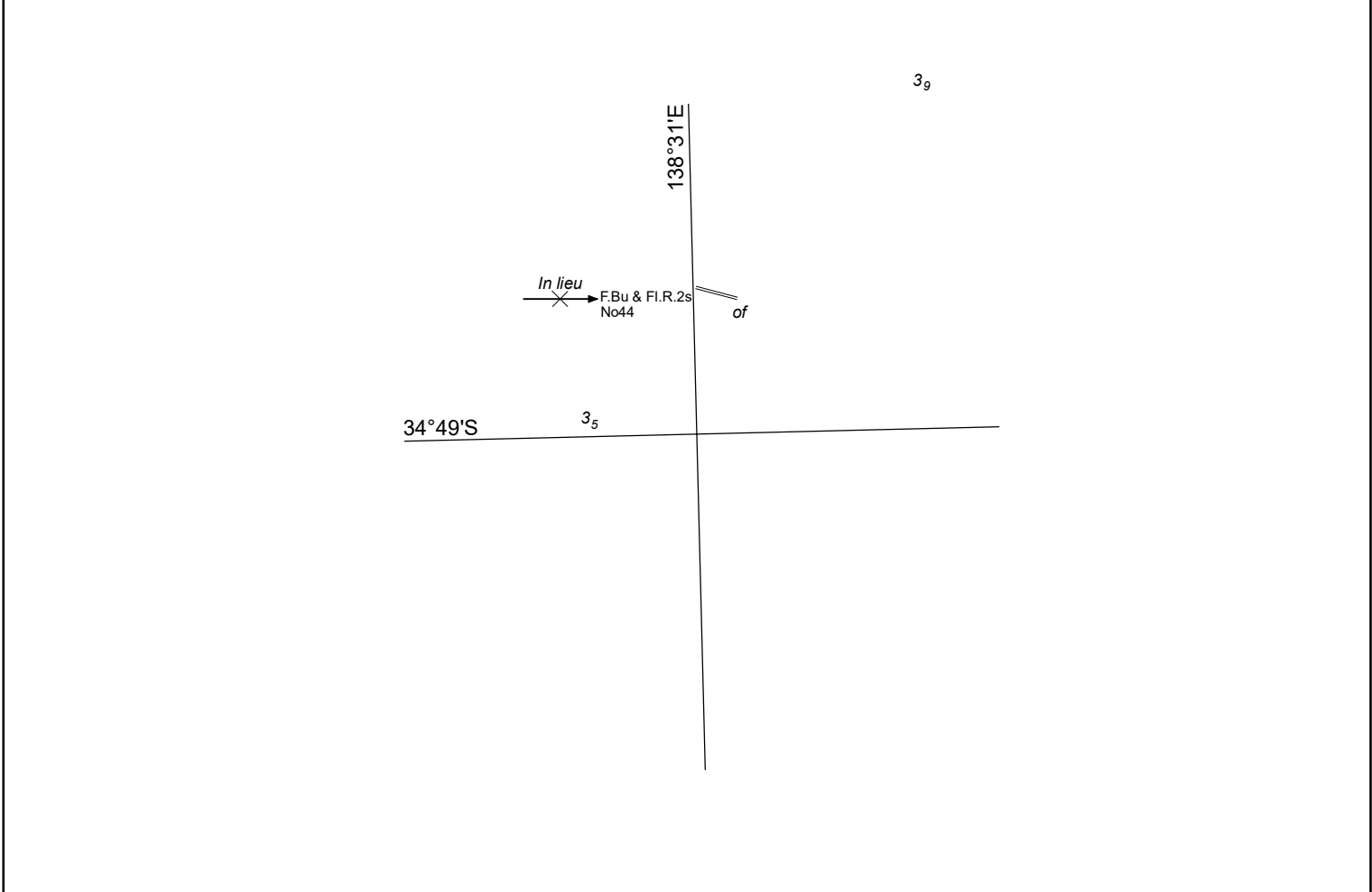
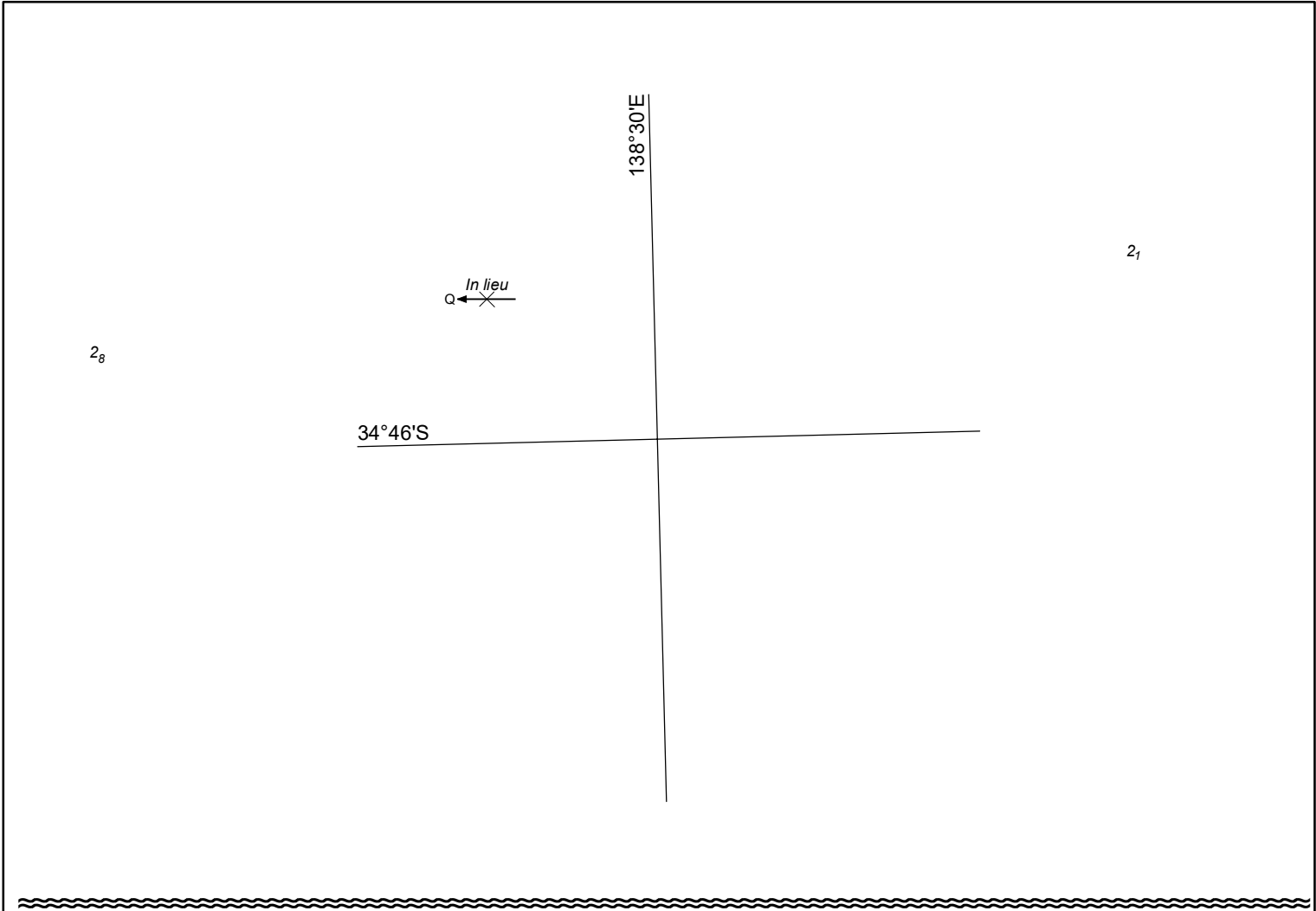

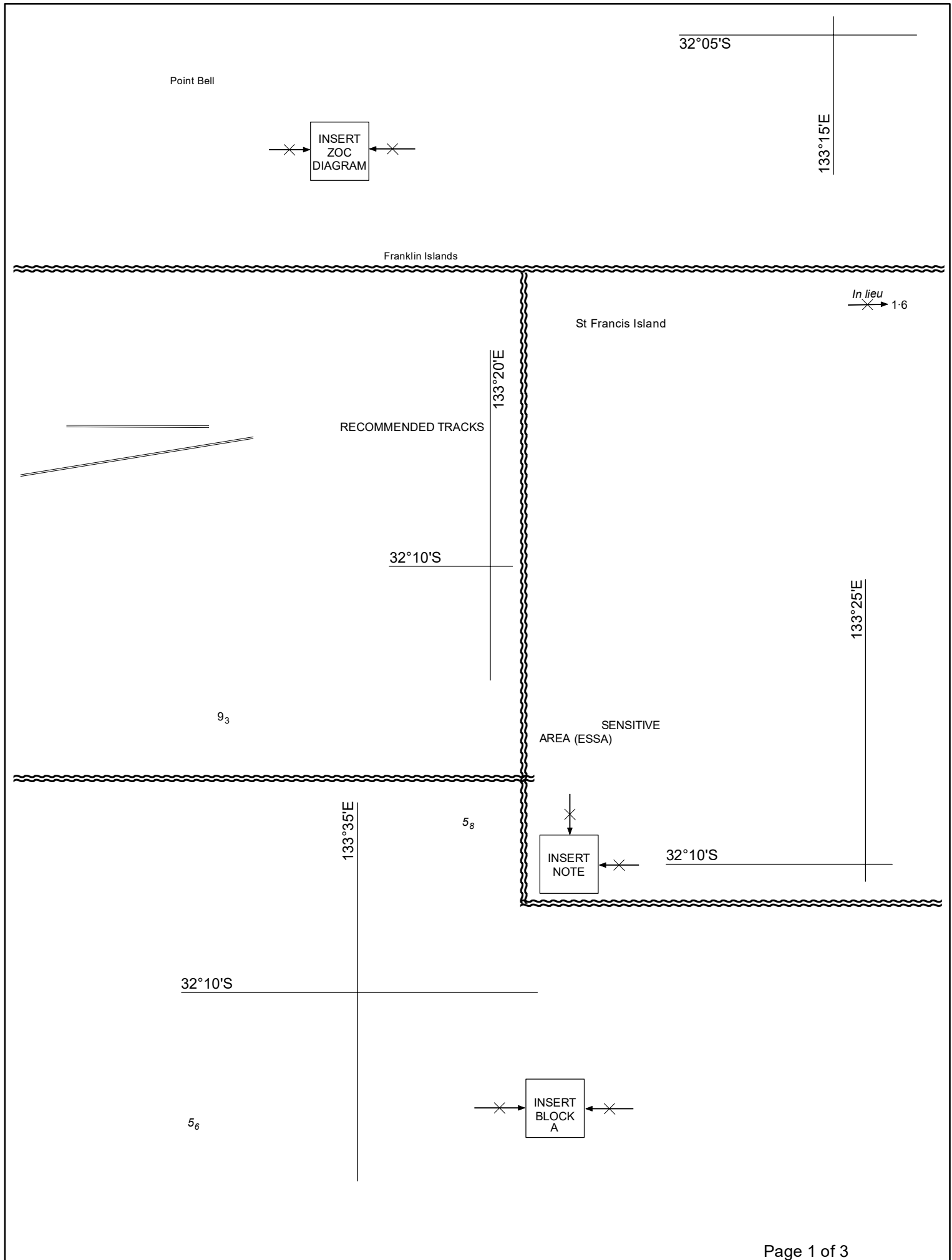

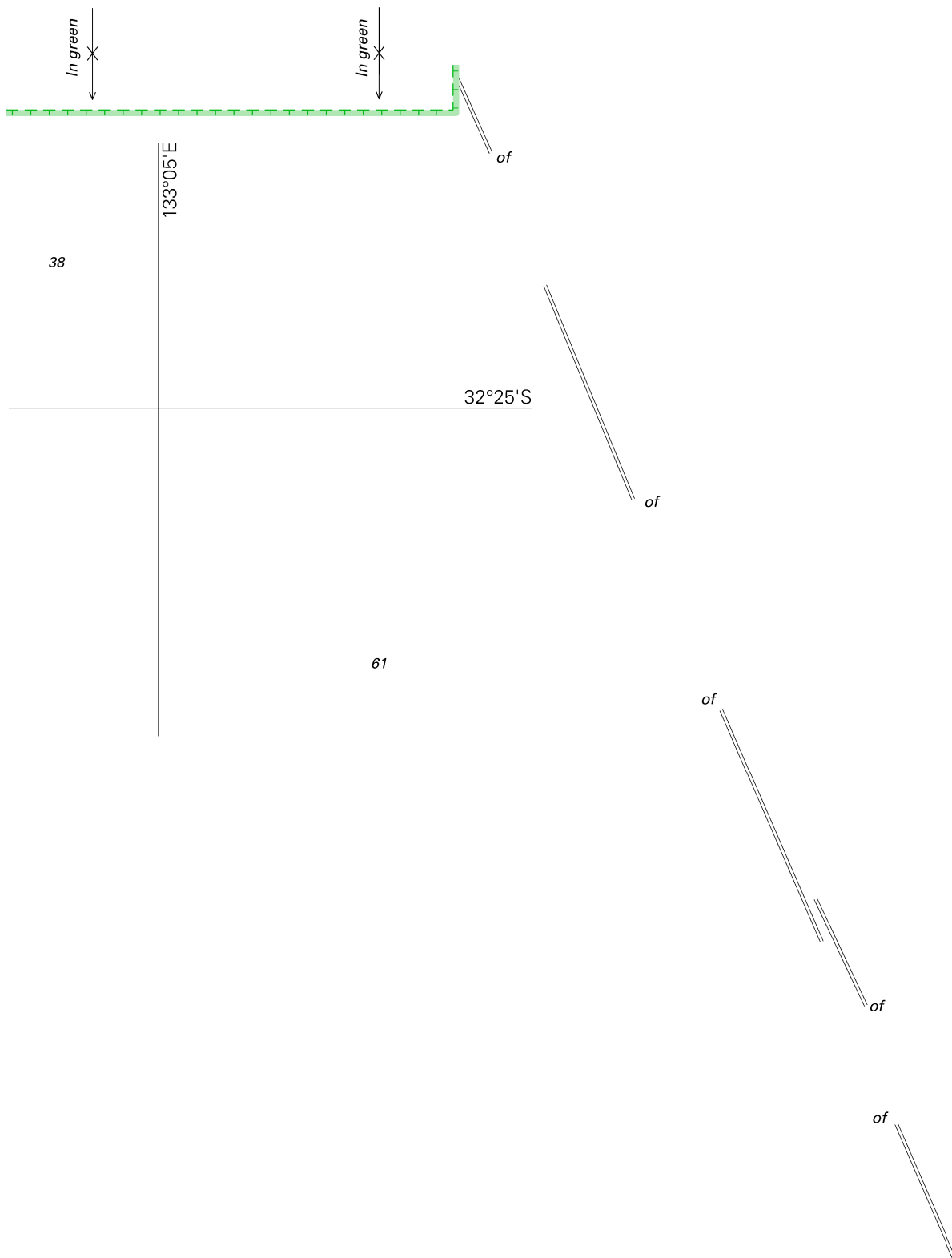

31°30'S

133°30'E

Cape Adieu

Ceduna

INSERT
ZOC
DIAGRAM

ENVIRONMENTALLY SENSITIVE SEA
AREA (ESSA)

INSERT
NOTE

INSERT
NOTE

32°00'S

129

100

134°20'08"E

27

INSERT
BLOCK

32°00'S

132°30'E

55



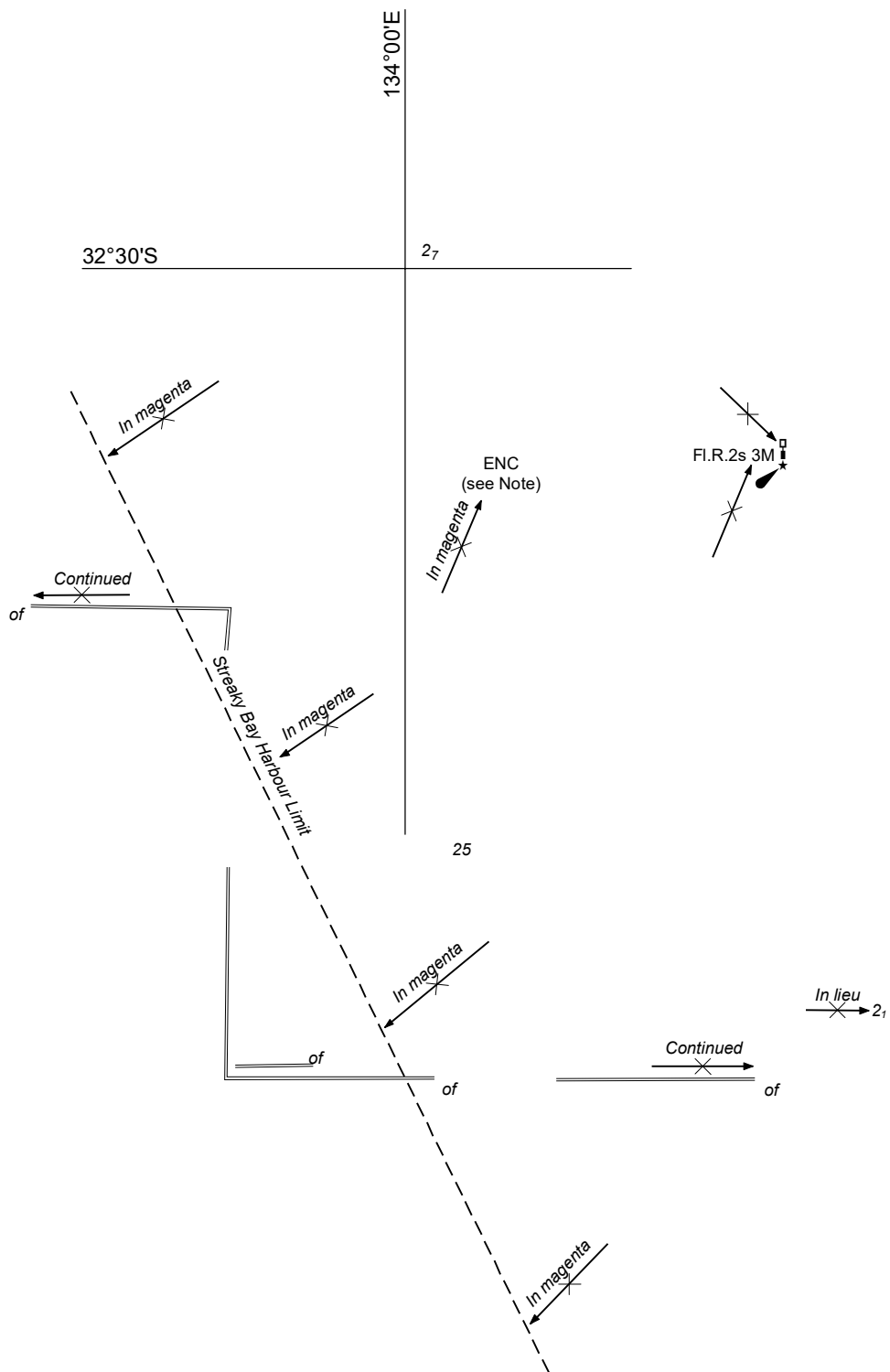

© Commonwealth of Australia 2020

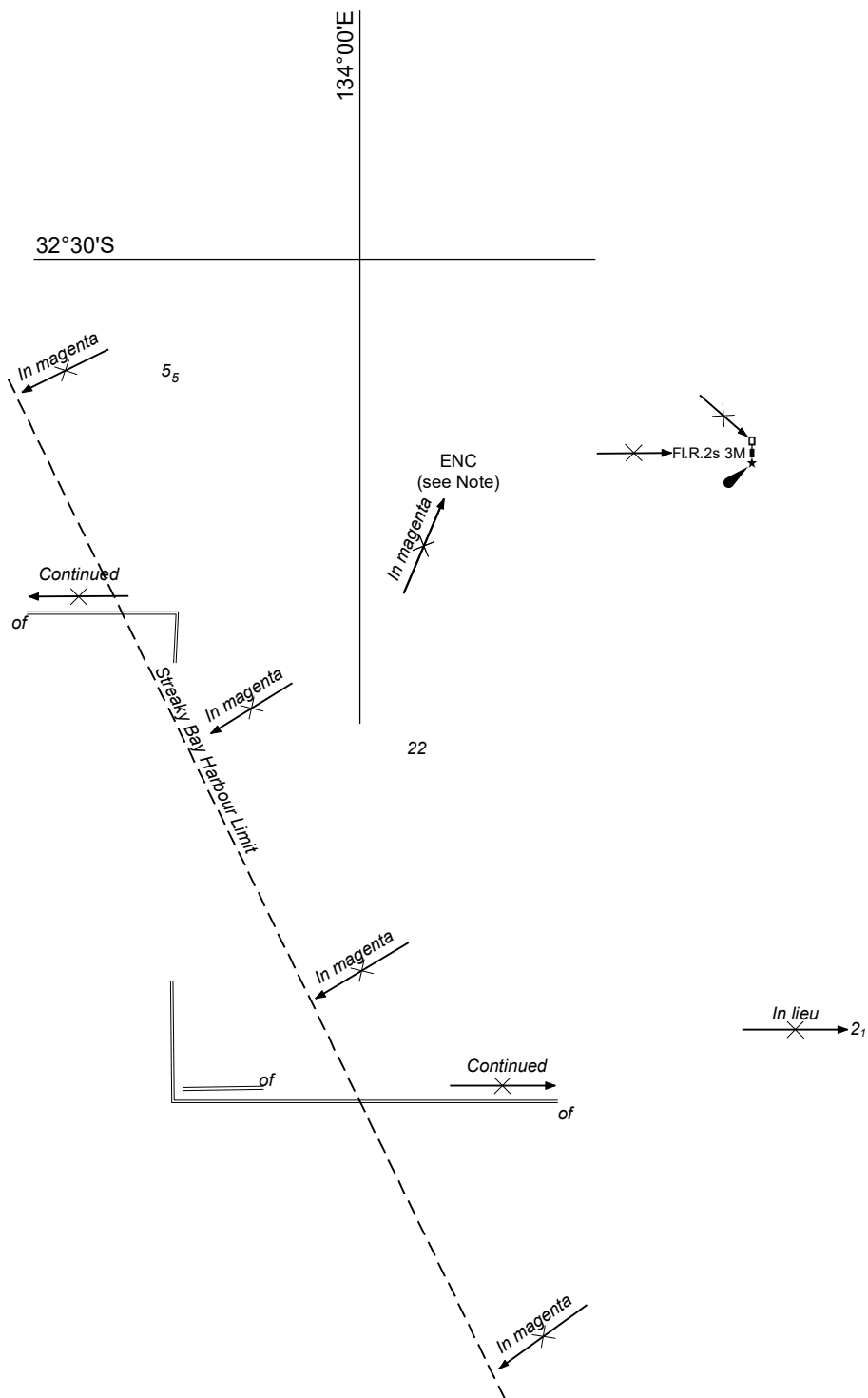

26₈

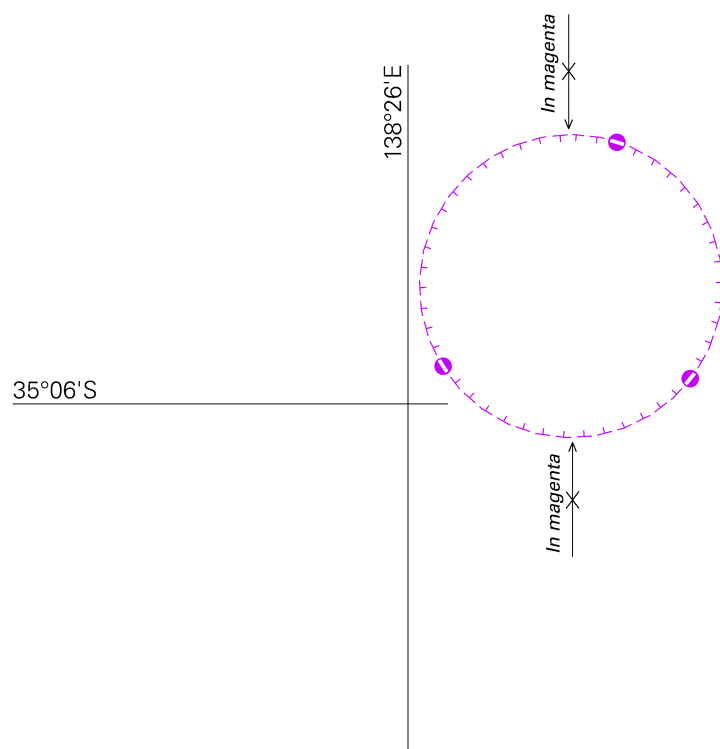

20₇

PLAN: PORT STANVAC

Previous Notice 150/2020

NTM 749/2020



AUS 125

© Commonwealth of Australia 2020

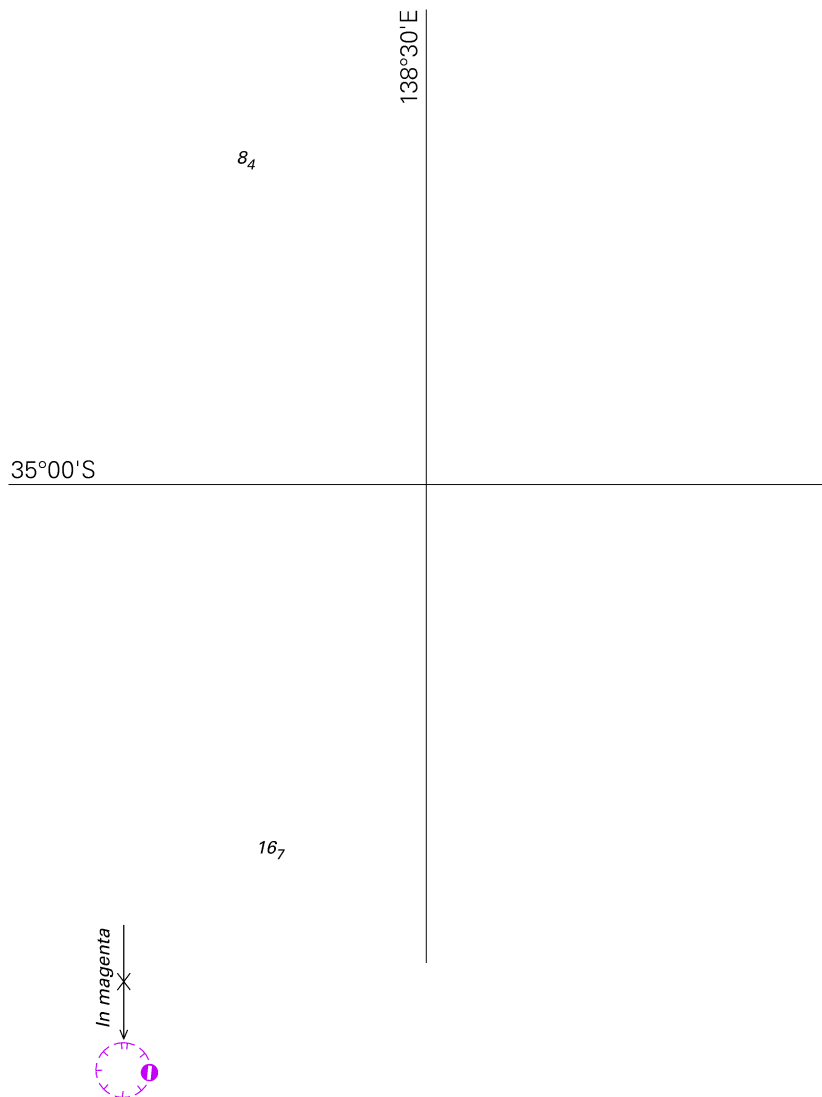

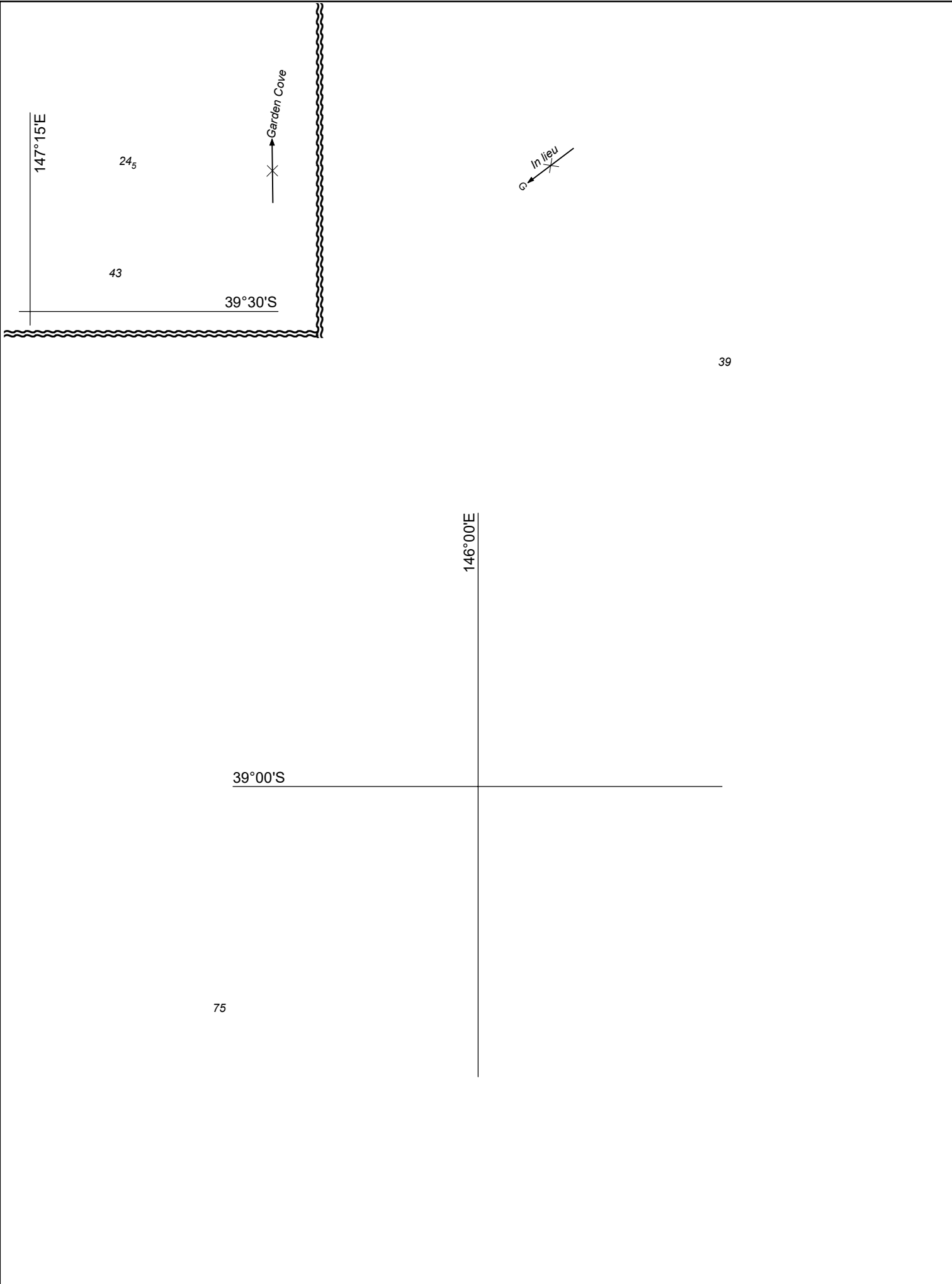

Q(3)10s
No30 BYB In lieu

4₉

145°12'E

38°19'S

4₃

PLAN: HASTINGS BIGHT

Previous Notice 113/2019

NTM 751/2020



Australian Government
Department of Defence

AUS 152

© Commonwealth of Australia 2020

4₄

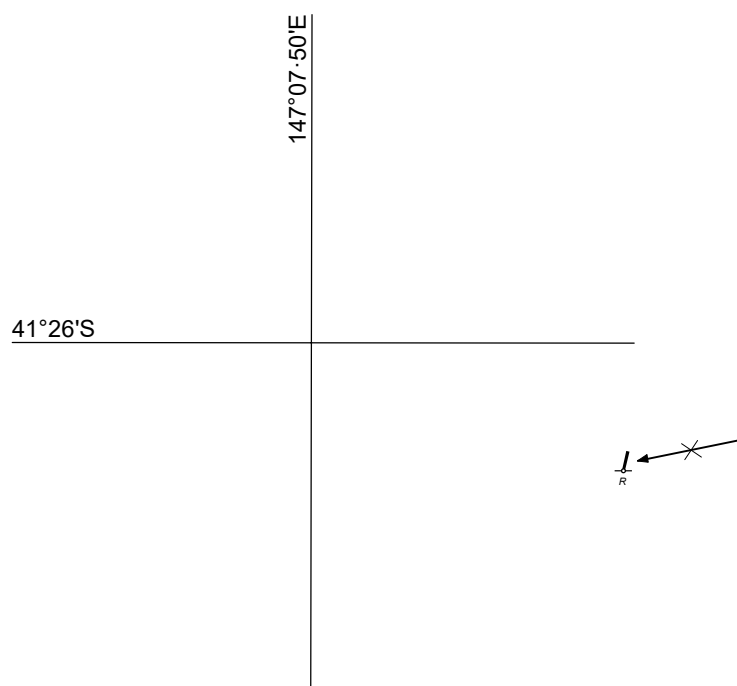

0₆

PLAN: LAUNCESTON WHARVES

Previous Notice 28/2020

NTM 753/2020



Australian Government
Department of Defence

AUS 168

© Commonwealth of Australia 2020