

of  
of

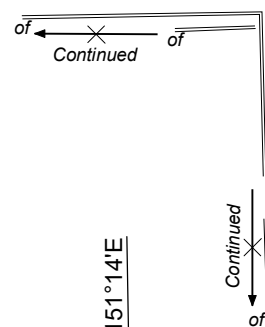

2<sub>4</sub>

5<sub>9</sub>

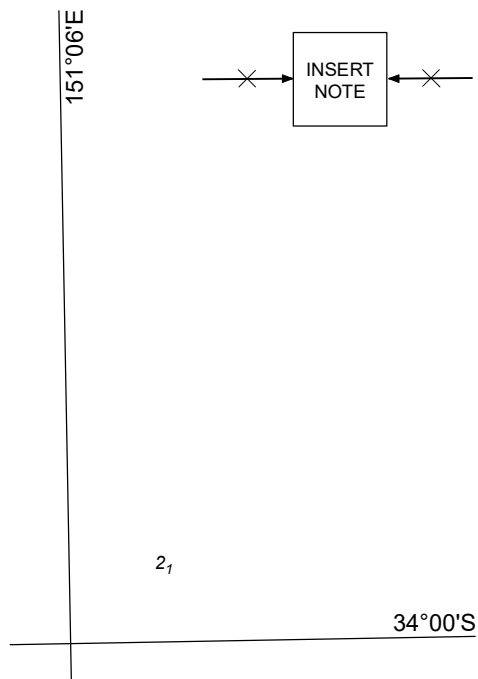
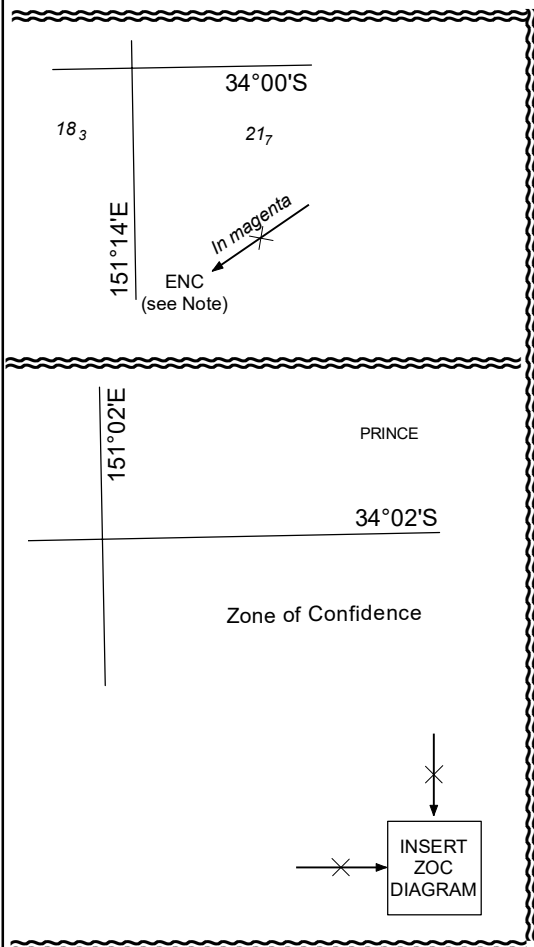
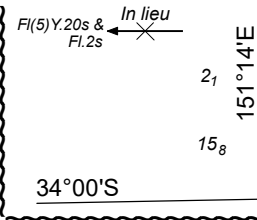
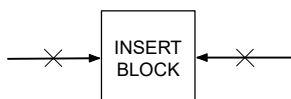

of of of

42

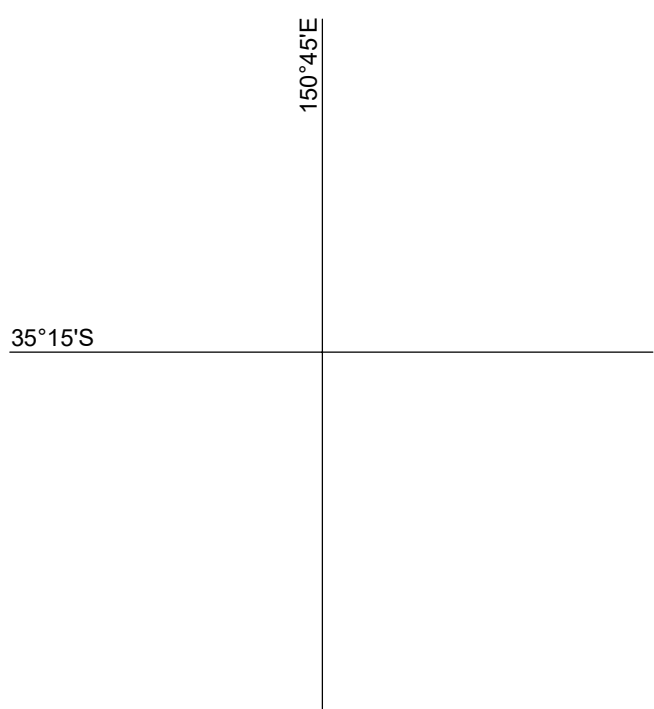

142



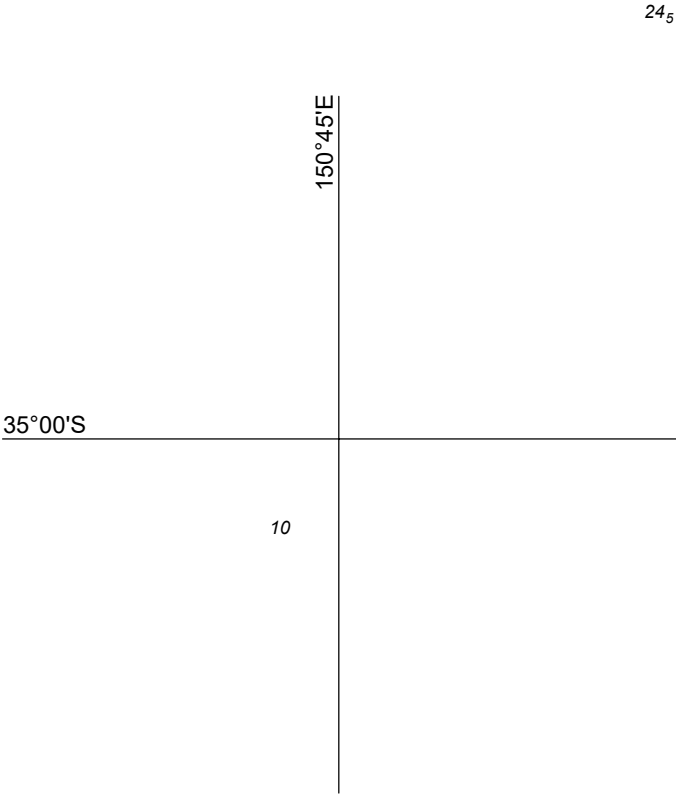

of of of



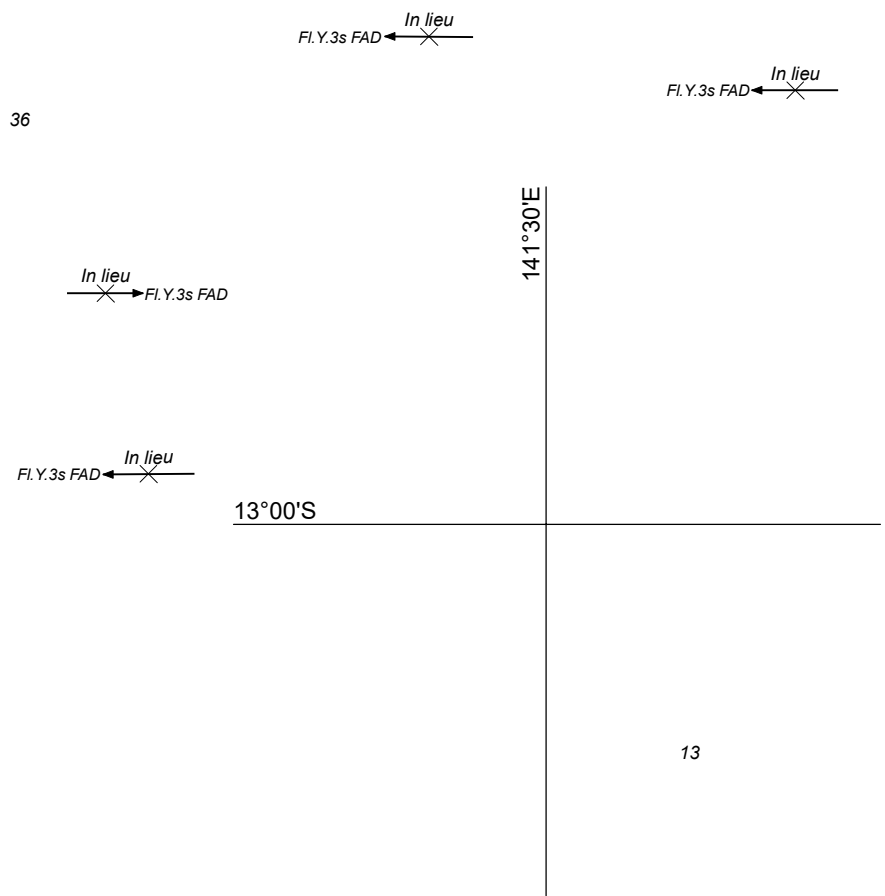

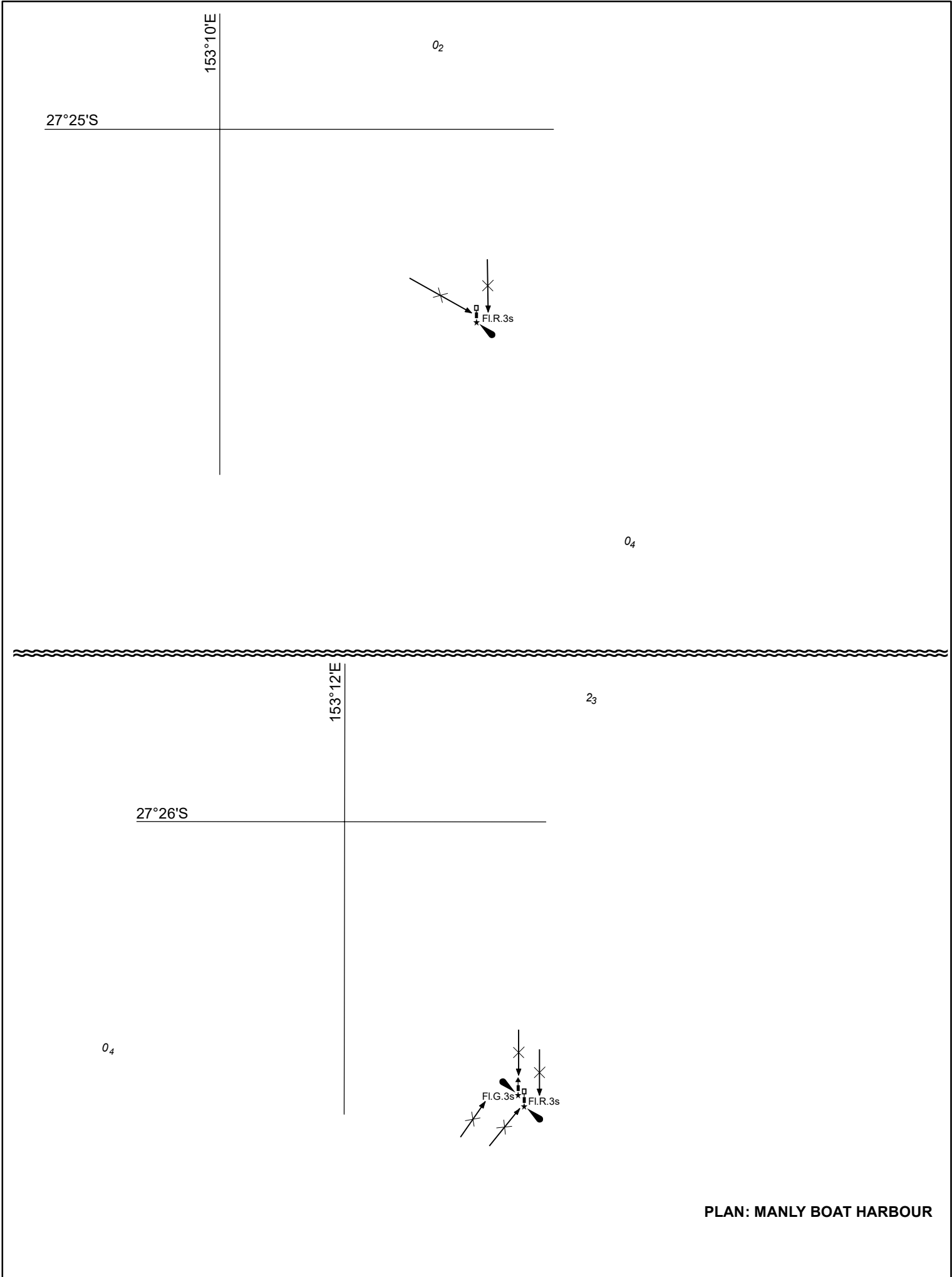

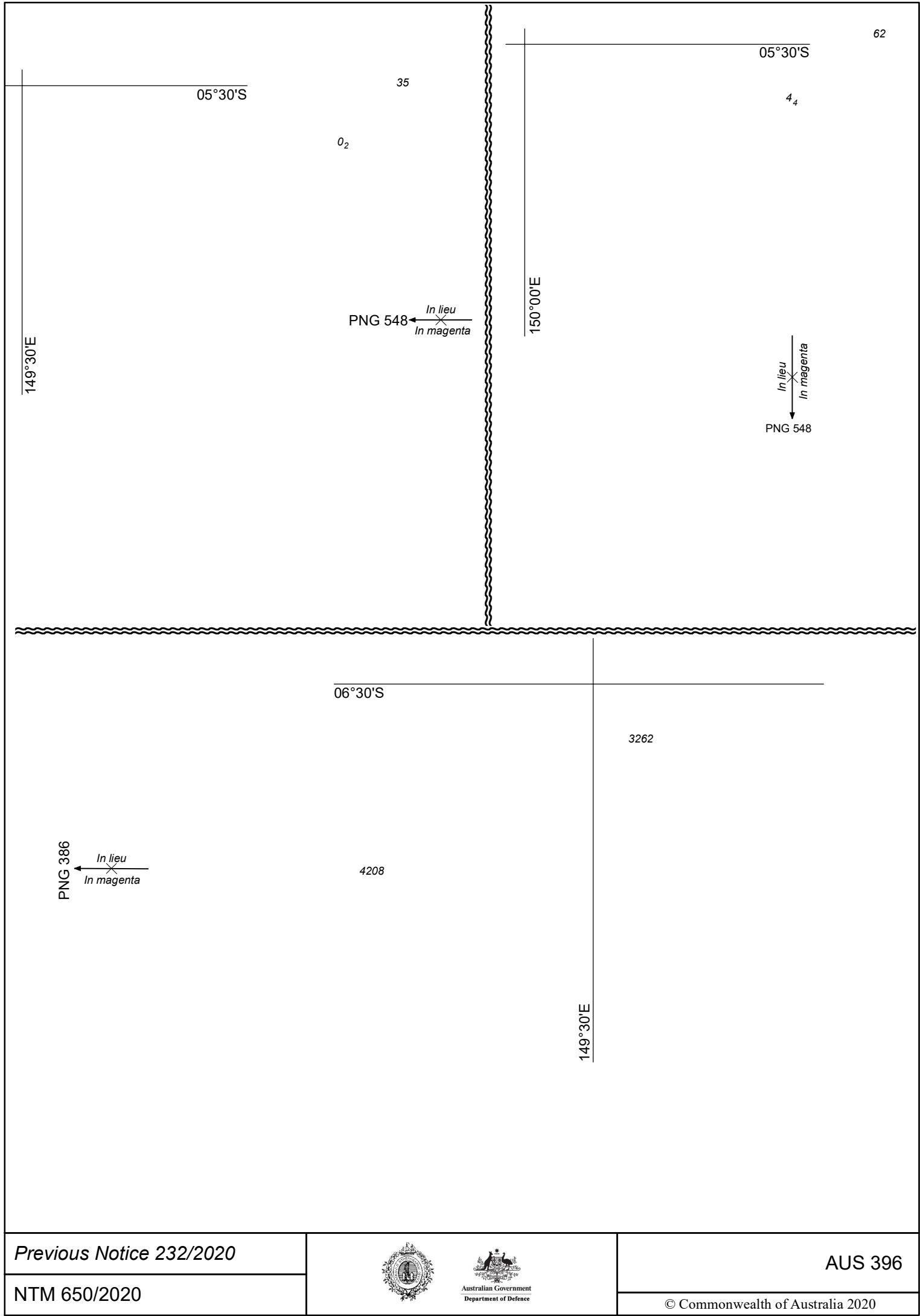

PNG 386 ← *In lieu*  
*In magenta*

150°00'E

4293

08°00'S

64

*Previous Notice 596/2020*

NTM 650/2020



AUS 4620  
(INT 620)

© Commonwealth of Australia 2020



PNG 386 ← *In lieu*  
*In magenta*

150°00'E

4432

08°00'S

298



318

150°00'E

04°00'S

PNG 386 ← ~~In lieu~~  
In magenta

PNG 548 ← ~~In lieu~~  
In magenta

989



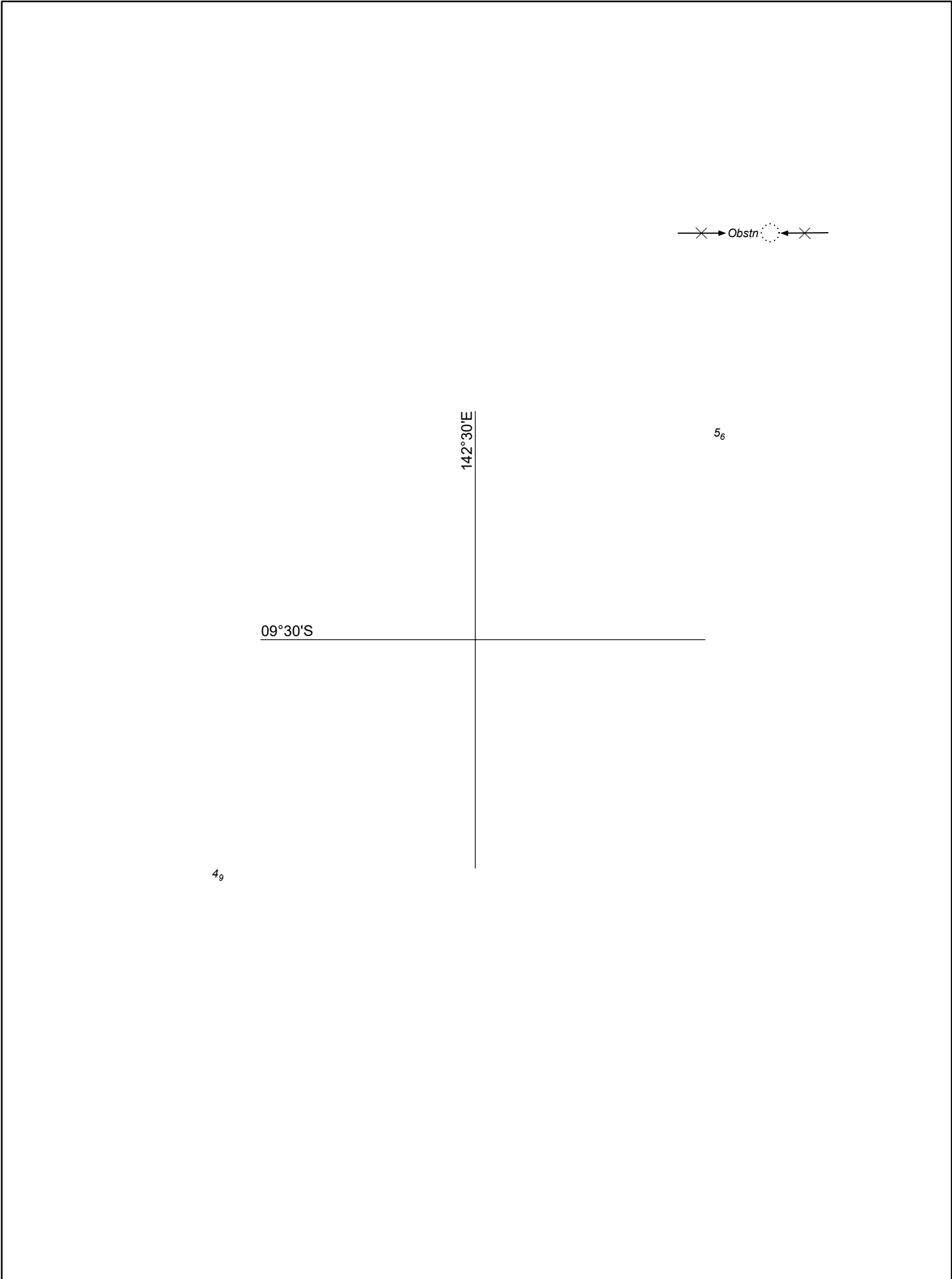

PNG 651 ← *In lieu*  
*In magenta*

2630

144°00'E

03°30'S

492

PNG 651 ← *In lieu*  
*In magenta*

Manam I

1047

Karkar I

145°00'E

04°51'·90'S

Previous Notice 370/2020

NTM 652/2020



AUS 388

© Commonwealth of Australia 2020

2215

03°00'S

143°30'E

2681 PNG 651 *In lieu*  
*In magenta*

Mount Pili

142°00'E

T O R R I C E L L I

03°30'S

PNG 651 *In lieu*  
*In magenta*

Previous Notice 413/2020

NTM 652/2020



AUS 389

© Commonwealth of Australia 2020

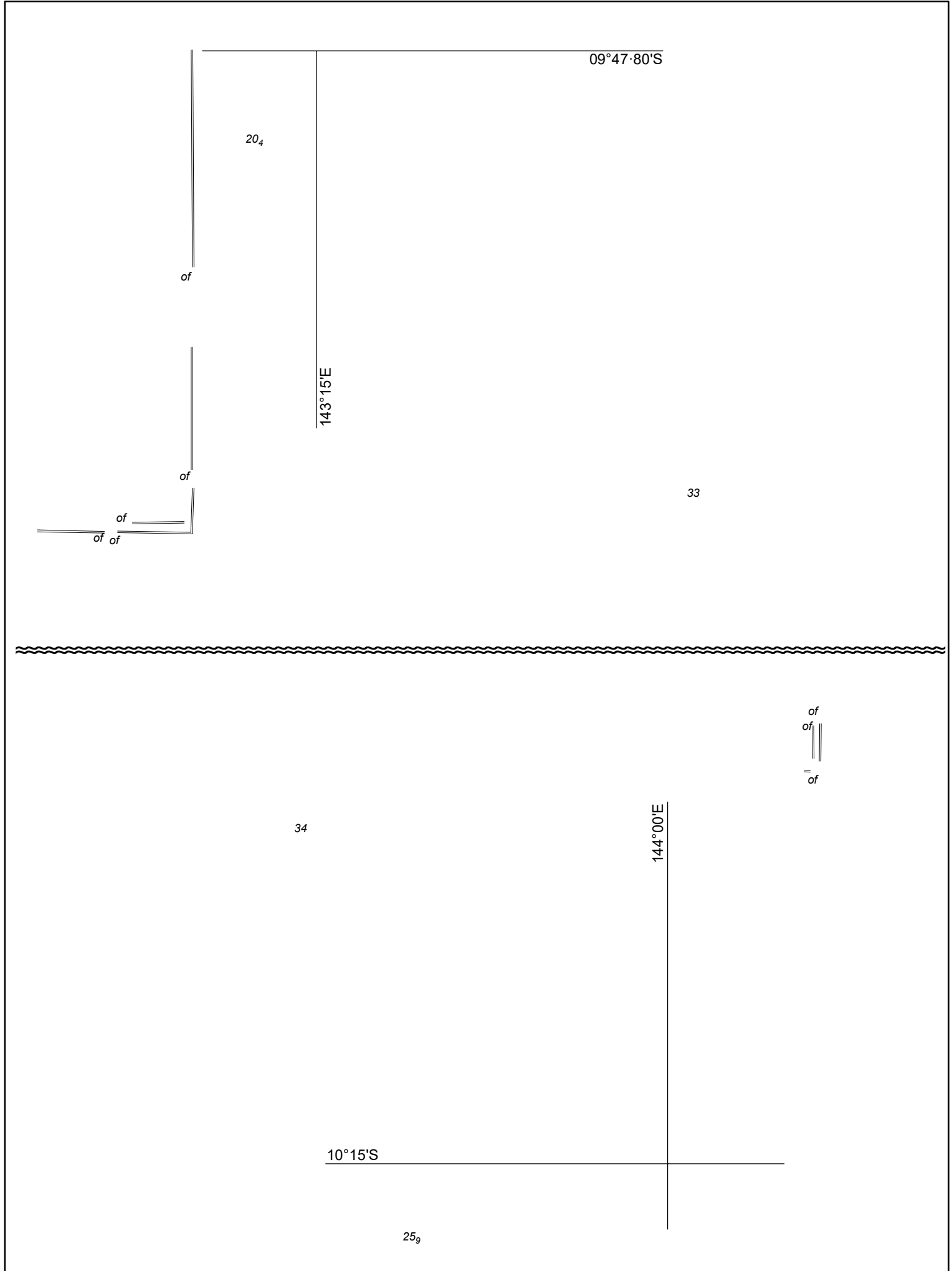

ENC  
(see Note) ← *In magenta*

143°00'E

Continued  
of

Continued  
of

Continued  
of

10°00'S

24

✕ → INSERT  
ZOC  
DIAGRAM ← ✕

Cairncross  
Islets

COMPULSORY PILOTAGE

✕ → INSERT  
NOTE  
↑ ✕

NINSULA

142°30'E

Jacky

11°00'S

11°20·80'S

142°30'E

Previous Notice 336/2020

NTM 653/2020



Australian Government  
Department of Defence

AUS 839

© Commonwealth of Australia 2020

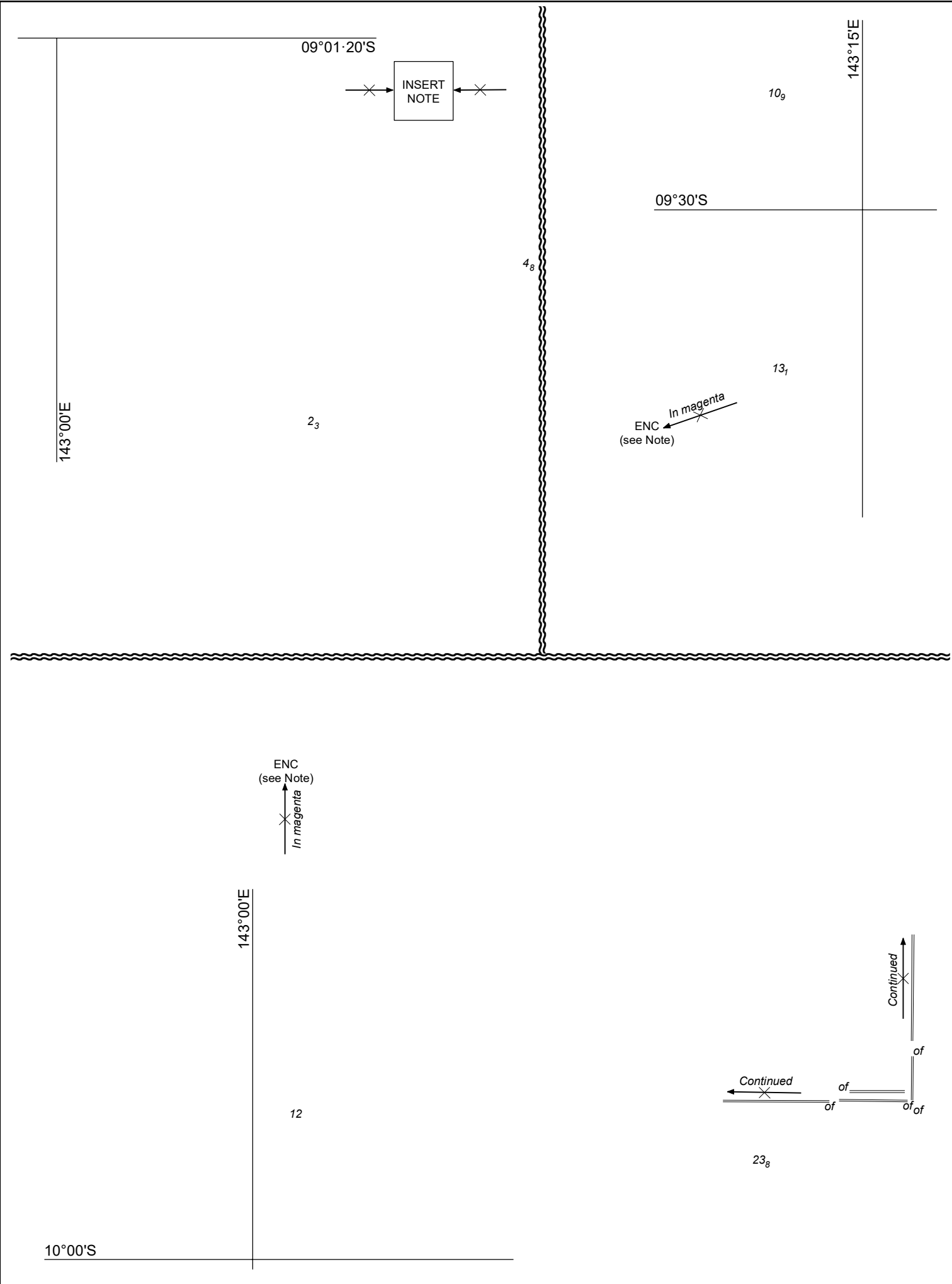



51

135°00'E

05°00'S

of

35

Previous Notice 480/2020

NTM 654/2020



AUS 4603  
(INT 603)

© Commonwealth of Australia 2020

82

of of

136°00'E

06°00'S

35



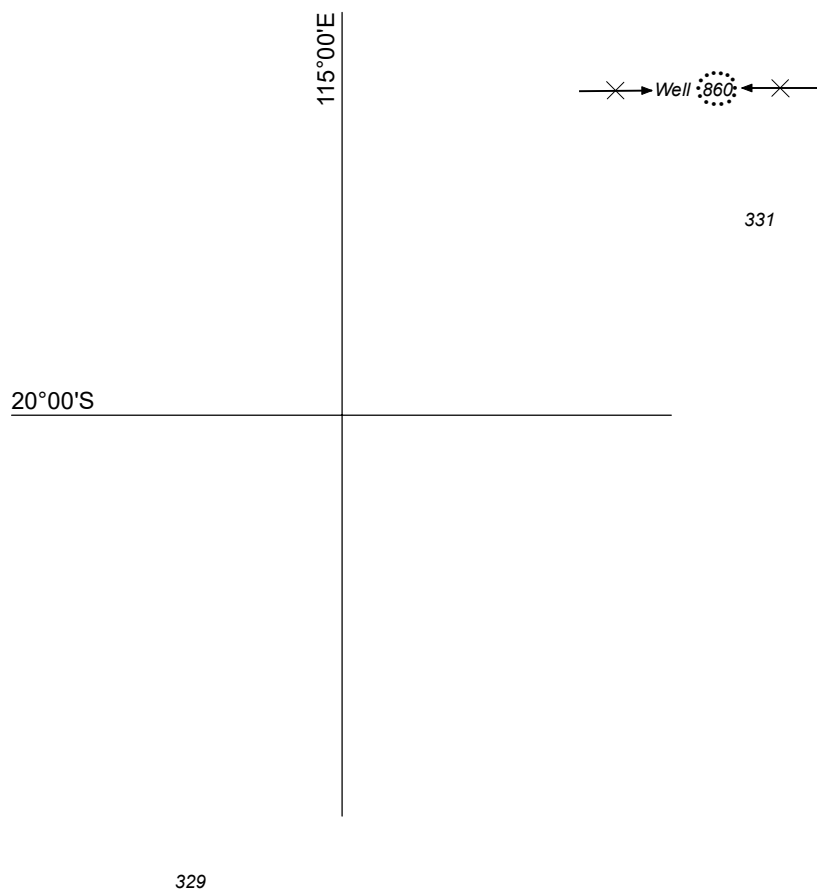

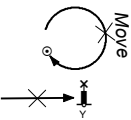
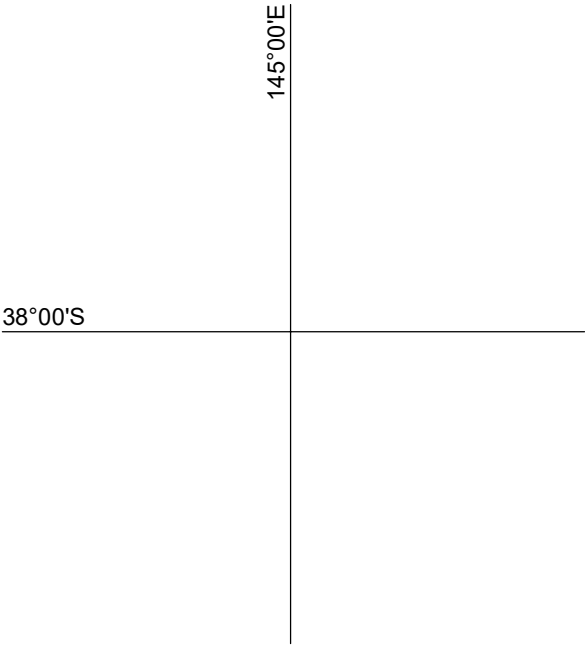

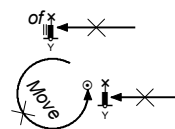
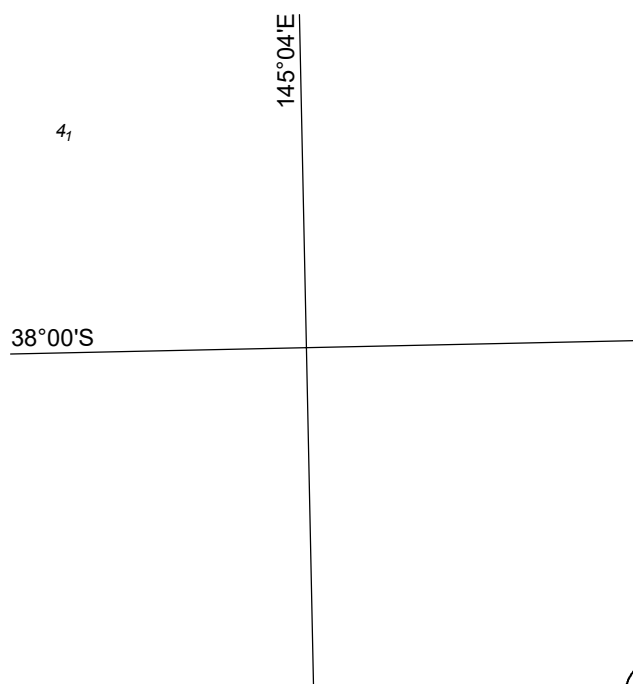

2<sub>9</sub>



of of of

147°00'E

48

39°00'S

146°00'E

22

39°00'S

53

of of of of

75

Previous Notice 416/2020

NTM 657/2020



Australian Government  
Department of Defence

AUS 487

© Commonwealth of Australia 2020